



## DESCRIPTION

The Wyndham Grand Clearwater Beach offers 343 luxuriously appointed guest rooms with spectacular vistas, the tranquil Pallavi Spa, and waterfront dining at the resort's signature restaurant, Ocean Hai, or Dock's Pool Bar & Grille. With over 22,000 square feet of flexible meeting space, including the area's largest ballroom, Wyndham Grand is transforming Clearwater Beach into a world-class event destination. Your experiences are limitless as you overlook the crystal gulf waters and experience dramatic sunsets painted on an infinite horizon.

## LOCATION

As a top year-round destination, Clearwater offers a seemingly endless supply of entertainment, natural beauty, and outdoor activities both on land and at sea. Caressed by tranquil Gulf breezes, its beaches offer miles of sugar-white sand, crystal clear waters and are consistently ranked among America's most beautiful! No one can afford to miss this ultimate destination, ideally situated on Florida's stunning West Coast and offering something for every visitor and every budget.

- Tampa International Airport: 30 Minutes
- St. Pete Clearwater International: 23 Minutes
- Orlando International Airport: 110 Minutes

## GUEST ROOMS

King Bedded Rooms	170
Double Queen Bedded Rooms	137
King Bunk Family Rooms	24
Suites	12
<b>TOTAL:</b>	<b>343</b>

## MEETING SPACE

The Wyndham Grand Clearwater Beach offers 22,000 square feet of flexible meeting and function space. The Dunes Ballroom is located on the main floor with tasteful decor and pre-function space to host over 700 guests. If you're looking for the perfect backdrop, the Pelican Room allows your guests to enjoy the spectacular Gulf of Mexico views.

### Meeting and function space:

Room Name	Square Feet
Dunes Ballroom	10,632 (Divides in to five sections)
Sandpiper Room	1,577 (Divides in to two sections)
Pelican Room	1,464
Heron Room	1,075
Egret Room	801
Ibis Room	797
Osprey Boardroom	380

Wireless internet access is available in guest rooms and throughout the hotel.



100 Coronado Drive, Clearwater, Florida 33767 | [www.wyndhamgrandclearwater.com](http://www.wyndhamgrandclearwater.com)

©2018 Wyndham Hotels and Resorts, LLC. All rights reserved. All Wyndham® hotels are either franchised by the company or managed by Wyndham Hotel Management, Inc. or one of its affiliates.

## MEETING SPACE CAPACITY CHART

Lobby Level	Square Feet	Dimensions	Banquet Rounds of 10	Reception	Classroom	Theatre	Crescent	Hollow Square	U-Shape
Dunes Ballroom	10,632	144' x 74'	720	1,080	612	1,136	406	n/a	n/a
Dunes I	1,785	48' x 38'	120	180	84	154	54	48	42
Dunes II	1,739	48' x 37'	120	180	84	140	54	48	42
Dunes III	3,584	48' x 74'	240	360	156	360	120	78	63
Dunes IV	1,739	48' x 37'	120	180	84	140	54	48	42
Dunes V	1,785	48' x 37'	120	180	84	154	54	48	42
Dunes Foyer	5,372	113' x 190'	n/a	550	n/a	n/a	n/a	n/a	n/a
Sandpiper	1,577	32' x 53'	100	140	66	110	56	48	42
Sandpiper I	773	32' x 26'	50	60	36	60	30	28	26
Sandpiper II	804	32' x 27'	50	60	36	60	30	28	26
Pelican	1,464	67' x 27'	80	150	48	90	42	40	38
Heron	1,075	33' x 36'	60	75	45	84	42	40	32
Egret	801	27' x 29'	50	60	36	60	30	28	26
Ibis	797	32' x 27'	50	60	36	60	30	28	26
Osprey Boardroom	380	30' x 15'	Executive Conference Table for 12						

*\*Our meeting room capacities have been calculated using the Meeting Professional International Comfort Calculator*

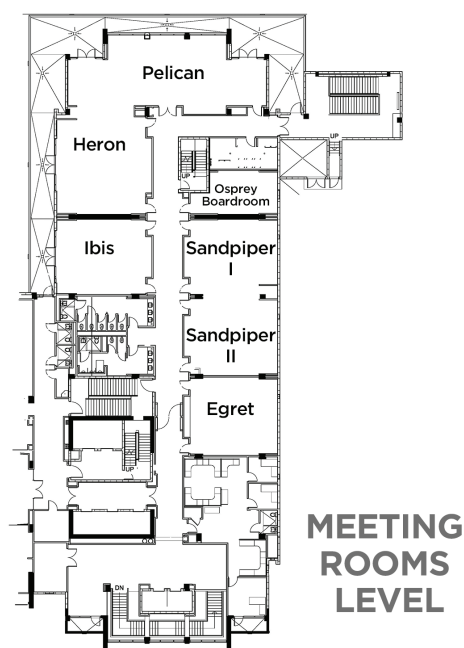

**MEETING  
ROOMS  
LEVEL**

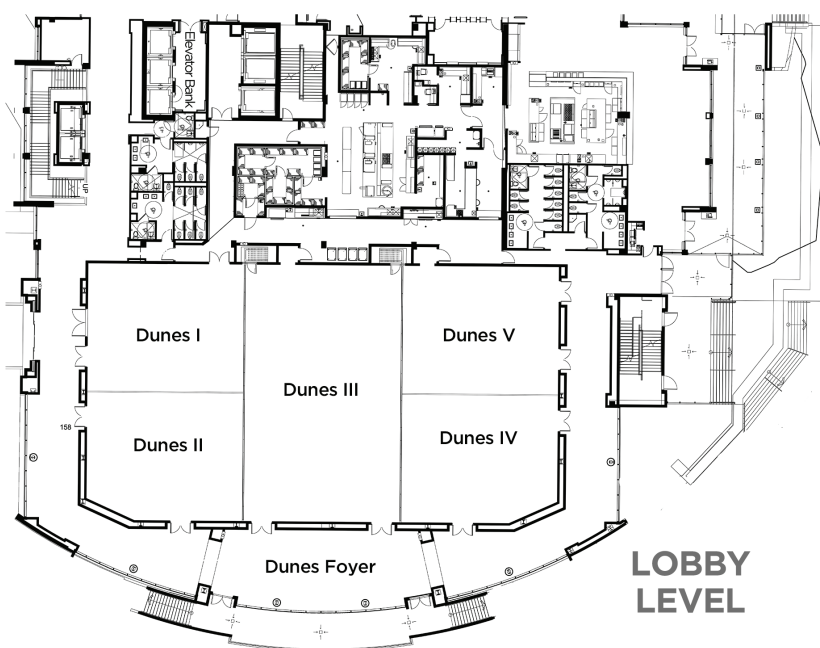

**LOBBY  
LEVEL**



100 Coronado Drive, Clearwater, Florida 33767 | [www.wyndhamgrandclearwater.com](http://www.wyndhamgrandclearwater.com)

©2018 Wyndham Hotels and Resorts, LLC. All rights reserved. All Wyndham® hotels are either franchised by the company or managed by Wyndham Hotel Management, Inc. or one of its affiliates.