

## FIRST FLOOR

- Lobby
- Front Desk
- Southern Host
- Boardroom
- Meeting Rooms
- Part & Parcel Bar

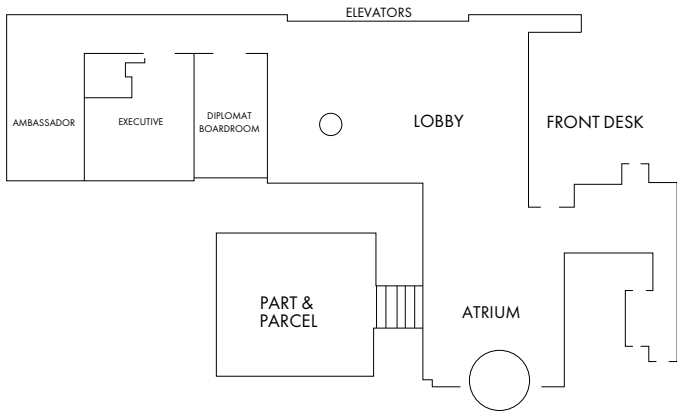

## SECOND FLOOR

- Art Gallery
- Edgar's Hermano
- Buffalo Bayou Coffee
- Ballrooms & Meeting Rooms
- Pool & Fitness Center

Maximum Capacities		Dimensions	Area	Max Ceiling Height	Theater	Classroom	Banquet	Conference	U-Shape	Hollow Square	Reception
1 <sup>st</sup> FLOOR	AMBASSADOR	16x35x10	494	10	70	20	40	24	20	23	35
	DIPLOMAT BOARDROOM	22x13x10	272	10	-	-	-	12	-	-	-
	EXECUTIVE	22x21x10	391	10	35	15	30	20	15	20	25
2 <sup>nd</sup> FLOOR	BAYOU BALLROOM	34x54x12	1920	11.5	200	95	130	60	55	60	180
	BAYOU A	33x17x12	556	11.5	60	30	40	25	20	25	60
	BAYOU A & B	34x44x12	1404	11.5	140	75	110	45	40	45	130
	BAYOU B	34x27x12	873	11.5	100	48	70	35	30	35	90
	BAYOU B & C	34x42x12	1373	11.5	130	65	100	40	35	40	120
	BAYOU C	34x15x12	510	11.5	50	30	30	25	20	23	40
	BLUEBONNET BALLROOM	58x77x12	4324	12	550	300	350	100	80	100	500
	BLUEBONNET A	58x35x12	1983	12	200	120	200	55	50	55	200
	BLUEBONNET B	58x42x12	2363	12	300	160	225	60	55	60	250
	COUGAR	20x37x10	615	10	60	30	50	30	25	30	50
	GULF COAST A	20x24x11	440	10.8	40	20	30	20	15	20	35
	GULF COAST B	20x28x11	474	10.9	40	20	30	20	15	20	35
	HOUSTON A	17x27x11	424	11	50	20	30	20	15	20	40
	HOUSTON B	17x34x11	540	11	50	20	30	20	20	24	40
WHITEHALL	35x29x15	905	15	110	50	80	40	30	40	100	