

ART+FOOD+LOVE

Art. Food. Love. It's what brings people together around the world, but especially in San Francisco. Park Central bridges these experiences and offers a fresh perspective on the city. Whether visiting for business or leisure (or a little bit of both), the hotel is ideally situated in the cultural heart of downtown, walking distance from Union Square, Oracle Park, the Financial District and Embarcadero, Chinatown, the Mission, and more. Gather for a green meeting at the Moscone Center, savor the flavors of the Ferry Building Marketplace, or immerse yourself in the contemporary arts at Yerba Buena Gardens and SFMOMA.

With eye-opening expansive views as your backdrop, spacious accommodations and a wide selection of room configurations make it comfortable to reconnect. High Speed Wi-Fi throughout the hotel ensures you never lose touch. Meet up for a breakfast meeting at the highly regarded MaSo, or sip a craft brew or locally roasted coffee at our contemporary bar & lounge. Communal workspaces featuring works by Bay Area artists plus complimentary beer tastings weekly make our lobby an inviting home office for the day.

Beyond what most tourists see of San Francisco, Park Central's exceptional guest services team connects travelers to a curated selection of insider experiences. See the city in a new light by engaging with the SF arts scene, discovering culinary delights, or exploring sports and cultural opportunities at the Chase Center. No matter what brings you here, or what you're passionate about, there are always new experiences to be had.



PARK CENTRAL HOTEL SAN FRANCISCO



A NEW PERSPECTIVE OF SAN FRANCISCO

Offering a curated selection of experiences, Park Central invites guests to see San Francisco in a fresh new way — engaging with the local arts scene, discovering culinary delights, and exploring unique wellness opportunities.



ART+FOOD+LOVE

PARKCENTRALSF.COM



ROOMS & SUITES

- 659 Guest Rooms & 22 Suites
- Smoke-Free Accommodations
- Floor-to-Ceiling Windows
- Panoramic Views
- High-Speed Wireless Internet Access for Up To 5 Devices (Daily Fee Applies)
- Turndown Service (Upon Request)
- ADA-Accessible Rooms Available
- 55" Flat-Screen TV
- Premium Cable TV & On-Demand Movies
- In-Room Safe
- Writing Desk with Ergonomic Desk Chair
- Iron & Ironing Board
- Hair Dryer
- Air Conditioning

SERVICES & AMENITIES

- MaSo Restaurant & Lounge
- MaSo On the Go
- MaSo Grab & Go Breakfast in Lobby, Weekdays Only, Starting at 6:30am
- 24-Hour Fitness Center
- Concierge Desk Open Daily, 11am-8pm
- Laundry & Dry Cleaning Services
- Car Rental & Valet Parking
- Notary Public Services, Monday to Friday, 10am-4pm
- Unlimited Local & 1-800 Phone Calls
- Seasonal Weekly Guided Morning Runs
- Complimentary In-Room Coffee, Tea & Bottled Water
- Complimentary Daily Wine Tasting & Hors d'Oeuvres, 6pm-7pm

UNRIVALED LOCATION

Conveniently located in the heart of San Francisco's most alluring shopping, dining, and entertainment attractions, Park Central boasts proximity to...

- 1 YERBA BUENA CENTER
- 2 FINANCIAL DISTRICT
- 3 MOSCONE CENTER
- 4 SFMOMA
- 5 UNION SQUARE
- 6 ORACLE PARK
- 7 CHINATOWN
- 8 FERRY BUILDING MARKETPLACE

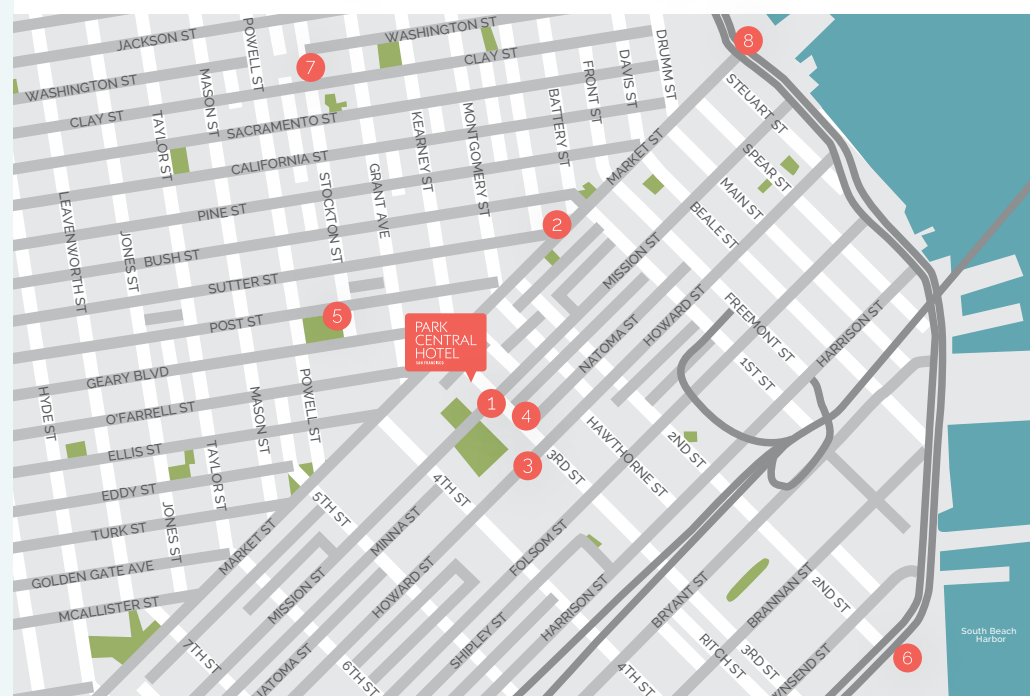

MEETINGS & EVENTS

Park Central Hotel San Francisco has 23,000 square feet of flexible function space, including a 9,000-square-foot Metropolitan Ballroom hosting up to 1,200 guests and 17 state-of-the-art meeting rooms accommodating groups from 12 to 150. The hotel also offers outdoor accommodations, including a beautifully landscaped patio area and elegant white tent for events year-round, no matter the weather. The award-winning Executive Chef can prepare custom menus for any occasion, and the hotel provides the latest in audiovisual technology.

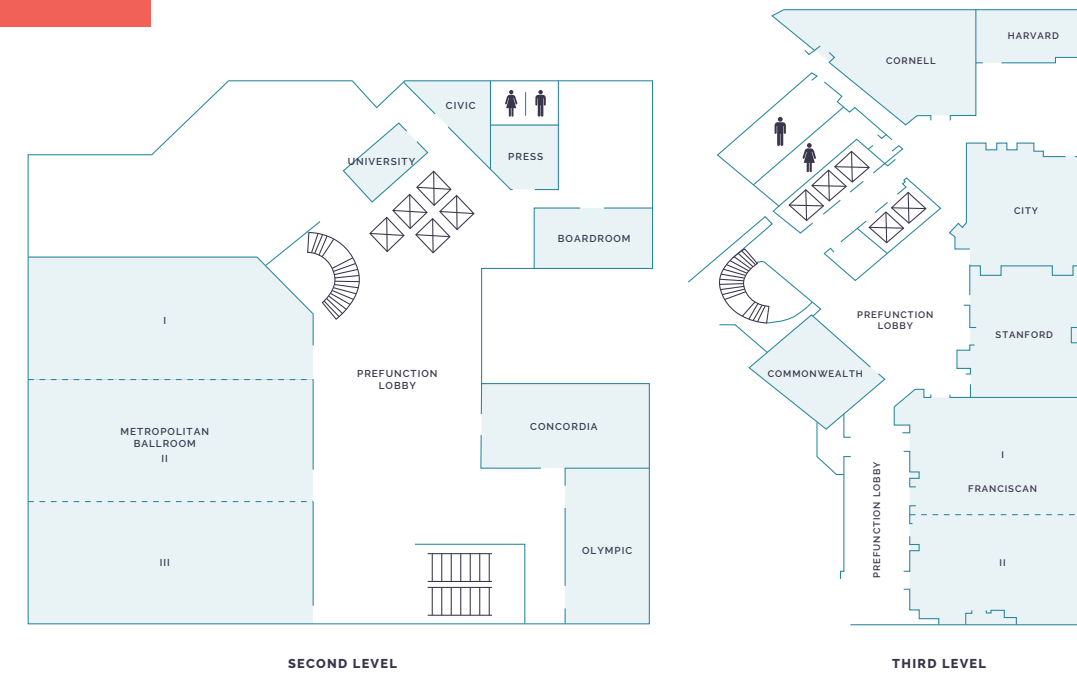

EVENT SPACE SPECS & CAPACITY CHART

ROOM NAME	TOTAL SQ. FEET	DIMENSIONS	CEILING	BANQUET	THEATER	CONFERENCE	RECEPTION	CLASSROOM	HOLLOW SQUARE	U-SHAPE	DINNER DANCE
SECOND LEVEL											
METROPOLITAN I	2,720	80' X 34'	16'	200	210	60	384	150	50	56	140
METROPOLITAN II	3,040	80' X 38'	16'	260	360	60	442	180	60	68	200
METROPOLITAN III	3,280	80' X 41'	16'	300	300	60	216	200	60	68	230
METROPOLITAN BALLROOM	9,040	80' X 114'	16'	750	1,042	194	1,042	640	225	230	600
OLYMPIC	897	39' X 23'	10'	80	61	35	61	50	34	38	—
CONCORDIA	893	47' X 19'	10'	50	57	30	57	40	30	34	—
BOARDROOM	720	40' X 18'	10'	—	—	16	—	—	—	—	—
PRESS	288	17' X 17'	10'	20	22	16	22	12	15	18	—
CIVIC	540	27' X 20'	10'	30	37	24	37	30	20	24	—
UNIVERSITY	476	28' X 17'	10'	20	27	16	27	16	15	18	—
THIRD LEVEL											
FRANCISCAN I	1,748	46' X 38'	10'	110	112	50	112	90	40	44	70
FRANCISCAN II	1,196	46' X 26'	10'	60	79	34	79	45	30	34	—
FRANCISCAN BALLROOM	2,944	64' X 46'	10'	190	191	84	191	150	40	45	120
CITY	992	32' X 31'	10'	60	65	30	65	50	32	36	40
STANFORD	1,050	35' X 30'	10'	60	70	30	70	50	32	34	40
COMMONWEALTH	546	26' X 21'	10'	40	38	24	38	30	20	24	—
CORNELL	1,184	37' X 32'	10'	60	77	30	77	36	30	34	—
HARVARD	420	28' X 15'	10'	—	—	12	—	—	—	—	—