

## MEET WITH CONFIDENCE | EVENT SPACE

Whenever and wherever you travel, InterContinental Miami is ready to meet you there. When you are ready to plan your next meeting or group event, you can book with confidence with our new flexible meeting offer.

Providing a safe, healthy, and clean stay for every traveler has always been important to us and this allows you to stay focused on your meeting objectives. Giving you the additional confidence in our approach is more critical to us than ever before. IHG will continue to refine and update the plan as guidance continues to evolve from global health organizations including the World Health Organization (WHO) and Centers for Disease Control (CDC), and state and local authorities.

	MEETING & FUNCTION SPACE						CAPACITY					
	Floor	Unit Sqft	Unit sqm	Length x Width (ft)	Height (ft)	Theatre Style	Classroom Style	U Shape	Crescent Rnd. of 3	Conference	Cocktail Reception	Banquet Style of 4
<b>Brickell</b>	Lobby	4,437	412	110x42	9'	57	57	24	54	-	57	88
<b>Merrick 1</b>	Lobby	885	82	35x26	9'	16	16	8	15	8	16	20
<b>Merrick 2</b>	Lobby	910	84	41x26	9'	14	12	7	12	10	14	24
<b>Grove</b>	Lobby	591	54	40x16	9'	7	7	-	6	8	7	12
<b>Trade</b>	Lobby	2,001	186	57x35	12'	38	38	14	27	12	38	40
<b>Flagler</b>	Lobby	961	89	31x31	11'	19	19	10	18	8	19	24
<b>Junior Ballroom</b>	Lobby	2,458	228	37x70	11'	28	28	-	36	-	30	60
Gusman	Lobby	774	72	37x22	11'	19	19	9	15	10	19	20
Tuttle	Lobby	893	83	37x24	11'	20	20	9	18	10	20	24
Dupont	Lobby	803	75	37x22	11'	19	19	9	15	10	19	20
Gusman/Tuttle	Lobby	1,662	154	37x47	11'	16	18	-	15	-	20	40
Dupont/Tuttle	Lobby	1,690	157	37x47	11'	16	18	-	15	-	20	40
<b>Marti</b>	Lobby	398	37	23x16	11'	4	4	7	6	6	4	8
<b>Fisher</b>	Lobby	263	24	25x16	8'	-	-	-	-	-	-	-
<b>Deering</b>	Lobby	247	23	13x19	10'	-	-	-	-	4	-	4
<b>Boardroom</b>	Lobby	450	42	19x27	10'	-	-	-	-	4	-	-
<b>Crandon</b>	Lobby	517	48	19x27	10'	10	10	7	6	6	10	8
<b>Godfrey</b>	Lobby	502	47	19x26	10'	10	10	7	6	6	10	8
<b>Bayfront Ballroom</b>	Lobby	7,219	670	119x94	20'	52	80	22	78	24	60	124
Bayfront A	Lobby	4,524	420	48x120	20'	45	55	17	57	20	45	68
Bayfront B	Lobby	2,696	250	45x63	13'	22	22	12	42	16	22	60
<b>Sevilla</b>	Lobby	3,776	351	63x60	10'	35	52	13	42	18	35	76
<b>Isles</b>	Lobby	1,963	182	60x36	12'	22	22	-	24	-	22	48
Hibiscus Isle	Lobby	939	87	28x36	12'	11	11	8	12	10	11	24
Star Isle	Lobby	579	54	31x36	12'	6	6	7	6	8	6	16
Palm Isle	Lobby	445	41	31x15	12'	6	6	7	6	6	6	8
Star/Palm	Lobby	1,024	95	31x51	12'	11	11	9	12	10	11	24



INTERCONTINENTAL  
MIAMI

## MEET WITH CONFIDENCE | EVENT SPACE

Whenever and wherever you travel, InterContinental Miami is ready to meet you there. When you are ready to plan your next meeting or group event, you can book with confidence with our new flexible meeting offer.

Providing a safe, healthy, and clean stay for every traveler has always been important to us and this allows you to stay focused on your meeting objectives. Giving you the additional confidence in our approach is more critical to us than ever before. IHG will continue to refine and update the plan as guidance continues to evolve from global health organizations including the World Health Organization (WHO) and Centers for Disease Control (CDC), and state and local authorities.

	MEETING & FUNCTION SPACE						CAPACITY					
	Floor	Unit Sqft	Unit sqm	Length x Width (ft)	Height (ft)	Theatre Style	Classroom Style	U Shape	Crescent Rnd. of 3	Conference	Cocktail Reception	Banquet Style of 4
<b>Grand Ballroom</b>	2nd Lvl.	13,248	1,236	192x69	16'	175	216	-	225	-	175	272
Versailles	2nd Lvl.	7,728	753	112x69	16'	105	117	-	120	-	105	160
Trianon	2nd Lvl.	5,520	516	80x69	16'	72	90	-	75	-	72	100
Floyer	2nd Lvl.	6,013	558	189x26	20'	-	-	-	-	-	75	96
<b>Mezzanine</b>	2nd Lvl.	12,565	1,167	-	20'	-	-	-	-	-	175	232
East	2nd Lvl.	5,132	477	-	20'	-	-	-	-	-	100	100
West	2nd Lvl.	5,132	477	-	20'	-	-	-	-	-	75	100
South	2nd Lvl.	2,300	214	-	20'	-	-	-	-	-	-	-
<b>Chopin Ballroom</b>	2nd Lvl.	5,293	492	52x110	21'	72	72	23	57	-	70	104
<b>Biscayne Ballroom</b>	2nd Lvl.	5,770	536	127x55	15' 10"	71	71	-	57	-	70	88
<b>Sandringham/ Windsor</b>	2nd Lvl.	1,784	166	25x70	15'	32	32	18	36	18	32	48
Sandringham	2nd Lvl.	877	81	25x35	15'	16	16	10	18	10	16	24
Windsor	2nd Lvl.	907	84	25x36	15'	16	16	10	18	10	16	24
<b>Balmoral</b>	2nd Lvl.	890	83	25x35	15'	16	16	10	18	10	16	24
<b>Escorial/Alhambra</b>	2nd Lvl.	1,239	115	26x47	13'	24	24	14	24	14	24	32
Alhambra	2nd Lvl.	618	57	26x23	13'	12	12	8	12	8	12	16
Escorial	2nd Lvl.	621	58	26x24	13'	12	12	8	12	8	12	16
<b>Raphael/ Michelangelo</b>	2nd Lvl.	1,226	114	26x47	13'	24	24	14	24	14	24	32
Raphael	2nd Lvl.	612	57	26x23	13'	12	12	8	12	8	12	16
Michelangelo	2nd Lvl.	614	57	26x24	13'	12	12	8	12	8	12	16
Oxford	2nd Lvl.	519	48	21x26	9'	8	6	7	9	7	8	12
Cambridge	2nd Lvl.	518	48	21x26	9'	8	6	7	9	7	8	12
Trinity	2nd Lvl.	520	48	21x26	9'	8	6	7	9	7	8	12
Registration Room	2nd Lvl.	304	28	19x16	9'	-	-	-	-	4	-	-
Sky Lawn	5th Lvl.	35,000	3,251	-	-	-	-	-	-	-	1,200	1,200
Upper Pool Terrace	5th Lvl.	8,479	788	125x72	-	-	-	-	-	-	100	92
Lower Pool Terrace	5th Lvl.	5,780	537	85x68	-	-	-	-	-	-	75	68

Subject to change without notice.

**InterContinental Hotel Miami**  
100 Chopin Plaza • Miami, FL 33131  
Tel. 305.577.1000 | ICMiamiHotel.com  
[IHG Travel Advisory Policy](#)

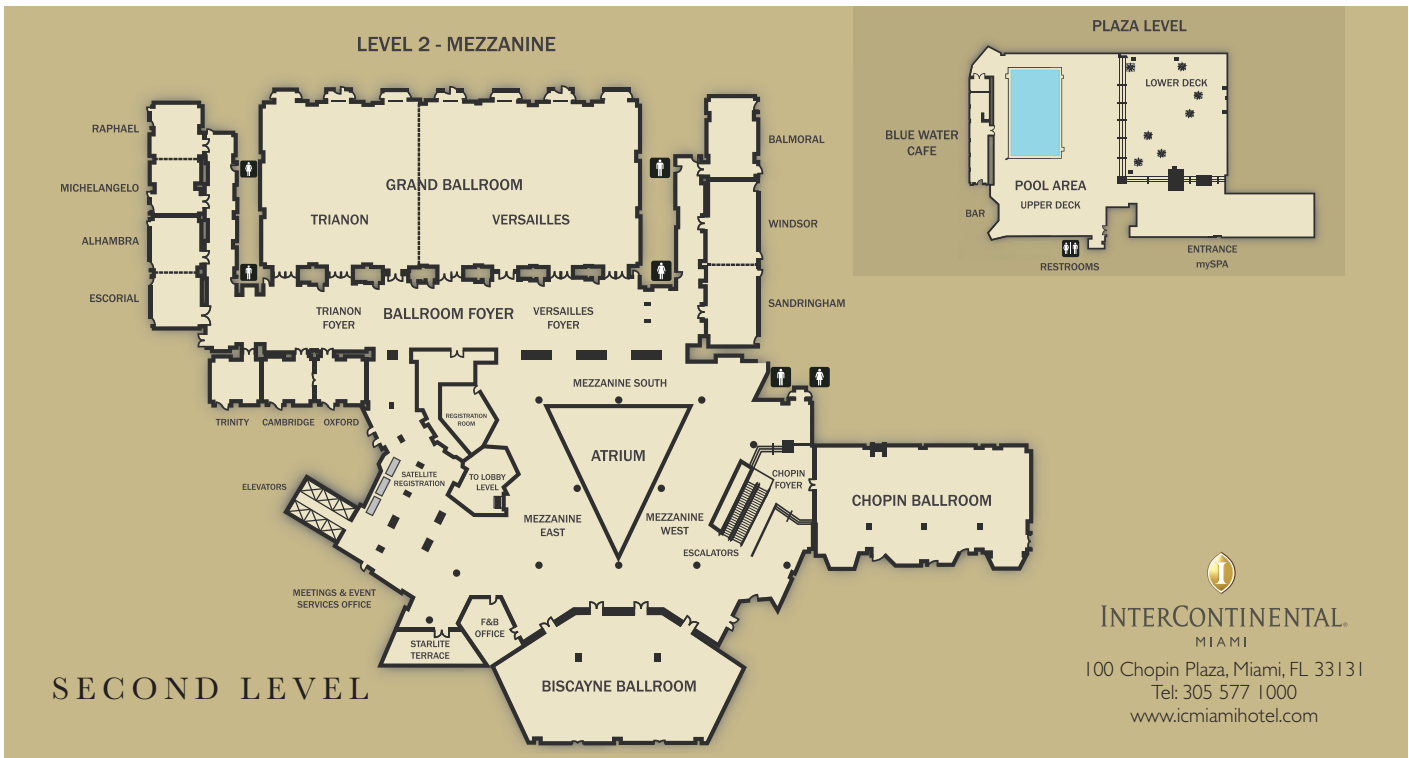

Subject to change without notice.

**InterContinental Hotel Miami**  
 100 Chopin Plaza • Miami, FL 33131  
 Tel. 305.577.1000 | ICMiamiHotel.com  
[IHG Travel Advisory Policy](#)