



INTERCONTINENTAL  
MIAMI

100 Chopin Plaza, Miami, FL 33131  
Tel: 305 577 1000  
www.icmiamihotel.com



## LOBBY LEVEL

Name of Room	Size (Sqft)	Size (Sqm)	Length x Width (ft)	Height (ft)	Theatre Style	Classroom Style	U-Shape	Crescent Rounds of 7	Conference	Cocktail Reception	Banquet Style
Brickell	4,437	412	110 x 42	9'	432	168	66	168	-	350	310
Merrick I	885	82	35 x 26	9'	84	33	18	28	18	50	50
Merrick II	910	84	41 x 26	9'	88	27	15	21	18	60	60
Grove	591	54	40 x 16	9'	45	18	-	-	18	30	30
Trade	2,001	186	57 x 35	12'	230	86	36	98	36	200	140
Flagler	961	89	31 x 31	11'	96	42	24	49	20	80	60
Junior Ballroom	2,458	228	37 x 70	11'	140	55	-	84	-	200	160
Gusman	774	72	37 x 22	11'	83	32	21	35	20	60	50
Tuttle	893	83	37 x 24	11'	96	36	21	42	20	60	60
Dupont	803	75	37 x 22	11'	83	32	21	35	20	60	50
Gusman/Tuttle	1,662	154	37 x 47	11'	100	39	-	35	-	110	110
Dupont/Tuttle	1,690	157	37 x 47	11'	100	39	-	35	-	110	110
Marti	398	37	23 x 16	11'	34	12	14	14	14	20	20
Fisher	263	24	25 x 16	8'	-	-	-	-	-	-	-
Deering	247	23	13 x 19	10'	18	-	-	-	8	-	10
Boardroom	450	42	19 x 27	10'	-	-	-	-	12	-	-
Crandon	517	48	19 x 27	10'	55	21	15	14	12	20	20
Godfrey	502	47	19 x 26	10'	55	21	15	14	12	20	20
Bayfront Ballroom	7,219	670	119 x 94	20'	520	198	60	280	64	550	480
Bayfront A	4,524	420	48 x 120	20'	360	126	45	189	54	350	300
Bayfront B	2,696	250	45 x 63	13'	224	87	30	112	28	200	180
Sevilla	3,776	351	63 x 60	10'	293	115	39	133	46	300	250
Isles	1,963	182	60 x 36	12'	122	54	-	56	-	180	120
Hibiscus Isle	939	87	28 x 36	12'	70	36	22	35	20	70	50
Star Isle	579	54	31 x 36	12'	48	18	18	14	18	30	30
Palm Isle	445	41	31 x 15	12'	30	12	15	14	14	30	20
Star/Palm	1,024	95	31 x 51	12'	90	36	21	35	22	60	50

LEVEL 2 - MEZZANINE

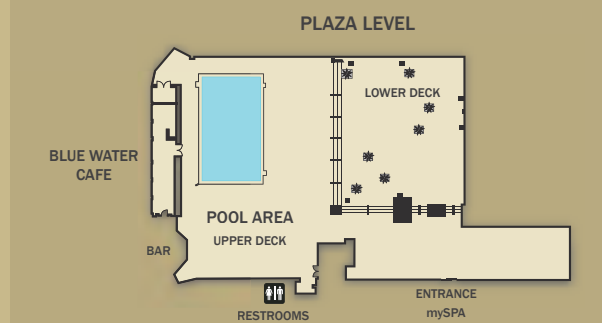

SECOND LEVEL

**INTERCONTINENTAL**  
MIAMI  
100 Chopin Plaza, Miami, FL 33131  
Tel: 305 577 1000  
www.icmiamihotel.com

Name of Room	Size (Sqft)	Size (Sqm)	Length x Width (ft)	Height (ft)	Theatre Style	Classroom Style	U-Shape	Crescent Rounds of 7	Conference	Cocktail Reception	Banquet Style
Grand Ballroom	13,248	1,236	192 x 69	16'	1,728	735	-	630	-	2000	1020
Versailles	7,728	753	112 x 69	16'	900	386	-	371	-	1200	600
Trianon	5,520	516	80 x 69	16'	646	294	-	252	-	800	420
Foyer	6,013	558	189 x 26	20'	-	-	-	-	-	500	320
Mezzanine	12,565	1,167	-	20'	-	-	-	-	-	2000	860
East	5,132	477	-	20'	-	-	-	-	-	1000	380
West	5,132	477	-	20'	-	-	-	-	-	1000	380
South	2,300	214	-	20'	-	-	-	-	-	-	-
Chopin Ballroom	5,293	492	52 x 110	21'	477	177	66	161	-	500	350
Biscayne Ballroom	5,770	536	127 x 55	15' 10"	422	192	-	203	-	550	410
Sandringham/Windsor	1,784	166	25 x 70	15'	205	72	41	84	48	120	120
Sandringham	877	81	25 x 35	15'	90	33	21	42	20	60	60
Windsor	907	84	25 x 36	15'	90	33	21	42	20	60	60
Balmoral	890	83	25 x 35	15'	90	33	21	42	22	60	60
Escorial / Alhambra	1,239	115	26 x 47	13'	142	48	30	56	30	100	80
Alhambra	618	57	26 x 23	13'	66	21	17	28	16	40	40
Escorial	621	58	26 x 24	13'	66	21	17	28	16	40	40
Raphael / Michelangelo	1,226	114	26 x 47	13'	142	48	30	56	30	100	80
Raphael	612	57	26 x 23	13'	66	21	15	28	16	40	40
Michelangelo	614	57	26 x 24	13'	66	21	15	28	16	40	40
Oxford	519	48	21 x 26	9'	44	14	17	15	20	30	30
Cambridge	518	48	21 x 26	9'	44	14	17	15	20	30	30
Trinity	520	48	21 x 26	9'	44	14	17	15	20	30	30
Registration Room	304	28	19 x 16	9'	-	-	-	-	6	-	-
Sky Lawn	35,000	3,251	-	-	-	-	-	-	-	1200	1200
Upper Pool Terrace	8,479	788	125 x 72	-	-	-	-	-	-	500	370
Lower Pool Terrace	5,780	537	85 x 68	-	-	-	-	-	-	300	250