

MEETING & EVENT SPACES

Allow our experienced team to arrange your memorable event in our 10,000 sq. ft. of flexible meeting space for up to 500 guests. Wired/wireless high-speed internet, state-of-the-art conference boardroom, audio-visual services, and lighting and sound packages are available, as well as personalized catering packages full of chef prepared specialties to please any palette. In addition, our Ballroom Foyer could easily pass for an art museum, thanks to a collection of permanent and rotating works by Savannah College of Art & Design artists.

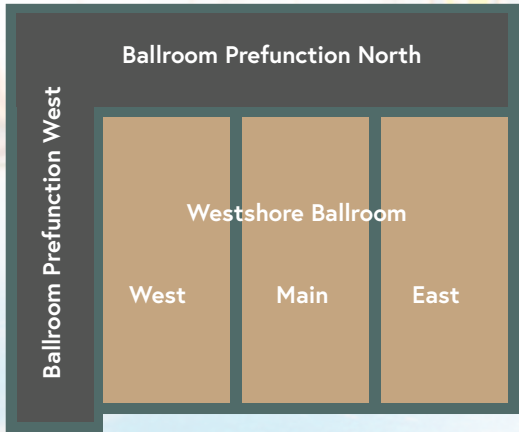

1ST FLOOR



2ND FLOOR

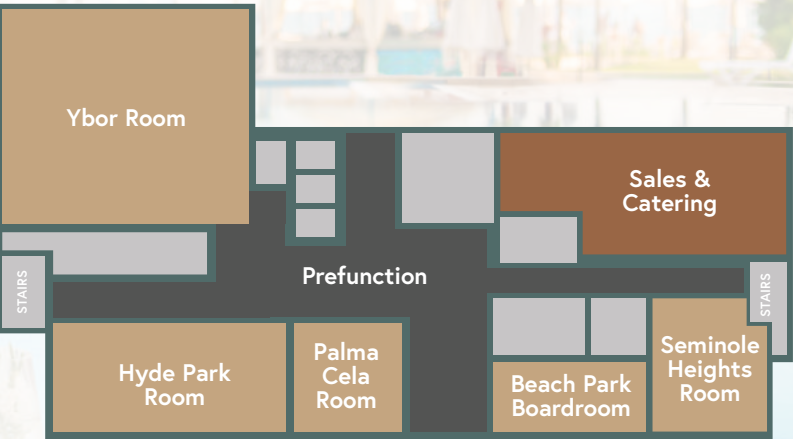

CAPACITIES & DIMENSIONS

MEETING ROOMS	DIMENSIONS	SQ. FT.	RECEPTION	THEATER	CLASSROOM MAX	BANQUET	U-SHAPE	CONFERENCE	CEILING HT. (FEET)
Westshore Ballroom	87 x 61	5307	600	600	288	420	96	120	13
Westshore Ballroom East	29 x 61	1769	150	160	96	120	56	64	13
Westshore Ballroom Main	29 x 61	1769	150	160	96	120	56	64	13
Westshore Ballroom West	29 x 61	1769	150	160	96	120	56	64	13
Ballroom Prefunction	-	2285	350	-	-	-	-	-	13
Ballroom Prefunction North	19 x 89	1691	200	-	-	-	-	-	13
Ballroom Prefunction West	14 x 84	1134	150	-	-	-	-	-	13
Ybor Room	48 x 42	2016	190	200	99	156	46	52	9
Hyde Park Room	21 x 40	840	60	70	42	48	36	42	9
Seminole Heights Room	23 x 25	575	60	60	27	36	27	36	9
Palma Ceia Room	21 x 21	441	30	40	21	24	18	24	9
Beach Park Boardroom	13 x 29	377	-	-	-	12	-	12	9

Note: All seating capacities are based on maximum numbers and do not take into consideration space needed for Dance Floors, Bar/stands, Head Tables, Buffets, AV Equipment, etc. Please contact our Sales Department for adjusted capacities according to your needs.

PLAN YOUR NEXT EVENT AT HOTEL ALBA. CONTACT SALES@HOTELALBA.COM

5303 WEST KENNEDY BOULEVARD, TAMPA FLORIDA 33609 | 813-289-1950 | FAX: 813-286-2563

HOTELALBATAMPA.COM



HOTELALBATAMPA.COM



OUR HOTEL

Guest Rooms & Suites: From airy ambiance to rich hardwood floors, modern, updated baths and locally inspired artwork, each of our 222 guestrooms are thoughtfully designed to make you feel right at home.

Pool Oasis: Our beautiful swimming pool with sundeck and seasonal cabana bar offers the perfect oasis for relaxing.

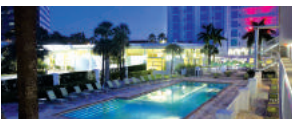

Fitness Center: Keep your workout routine going in our state-of-the-art Fitness Center, complete with the latest generation cardio and strength training machines.

Event Planning: Elevate conventions, executive board meetings, parties and weddings to the next level with 10,000 sq. ft. of adaptable meeting space, including an unforgettable outdoor terrace.

Art Gallery: Hotel Alba is proud to have its own custom-curated art gallery featuring art inspired by the culture and beauty of Tampa and created by students, faculty, and alumni of SCAD.

LOCATION. LOCATION. LOCATION.

Located on the west coast of Florida, the city of Tampa is home to tourist destinations suited for guests of all ages. Whether you're looking to spend a fun-filled day with the kids at Busch Gardens & Adventure Island or cheer on the Tampa Bay Buccaneers or Tampa Bay Lightning, Hotel Alba's location is central to all the fun that Tampa has to offer. The hotel is also situated across the street from Westshore Plaza and only three miles away from high-end shopping and restaurants at International Plaza.

Ybor City, Tampa Bay's National Historic Landmark District, will appeal to those looking for some authentic Florida flavor.

Columbia Restaurant, Florida's oldest restaurant founded in 1905 by a Cuban immigrant, is the largest Spanish restaurant in the world.

Port of Tampa, which docks major cruise lines that now cruise to Cuba, also features local shops and restaurants.

A Thriving Craft Beer and Culinary Scene, featuring breweries like Cigar City Brewing, whose Cubano-Style Espresso Brown Ale reflects the sensibilities and ingredients of Florida, or Coppertail Brewing Co., an independently-owned production brewery and tasting room in historic Ybor City.



HOTEL DINING

The Spaniard: Hotel Alba's signature restaurant features casual, open-air dining with delectable Spanish-inspired dishes that draw inspiration from Tampa's culture, culinary traditions, and local ingredients as well as a lineup of creative cocktails and craft brews.

Buffalo Bayou: Proudly serving local roasts, Buffalo Bayou Coffee also offers a variety of homemade baked goods, sandwiches, salads and beer and wine by the glass.



Conveniently located between downtown Tampa and Clearwater Beach and within a five-minute drive to Tampa International Airport, Hotel Alba offers a boutique hotel experience steeped in true Southern hospitality and style that aims to provide travelers with a unique local experience in the Westshore business district. The Spanish word for sunrise, "alba" is a historic nod to the rise of Tampa's cigar industry in the late nineteenth century, a transformative shift that ushered in the cultural diversity and economic prosperity that continues to define Tampa today. So, welcome to Tampa. Welcome home to Hotel Alba.

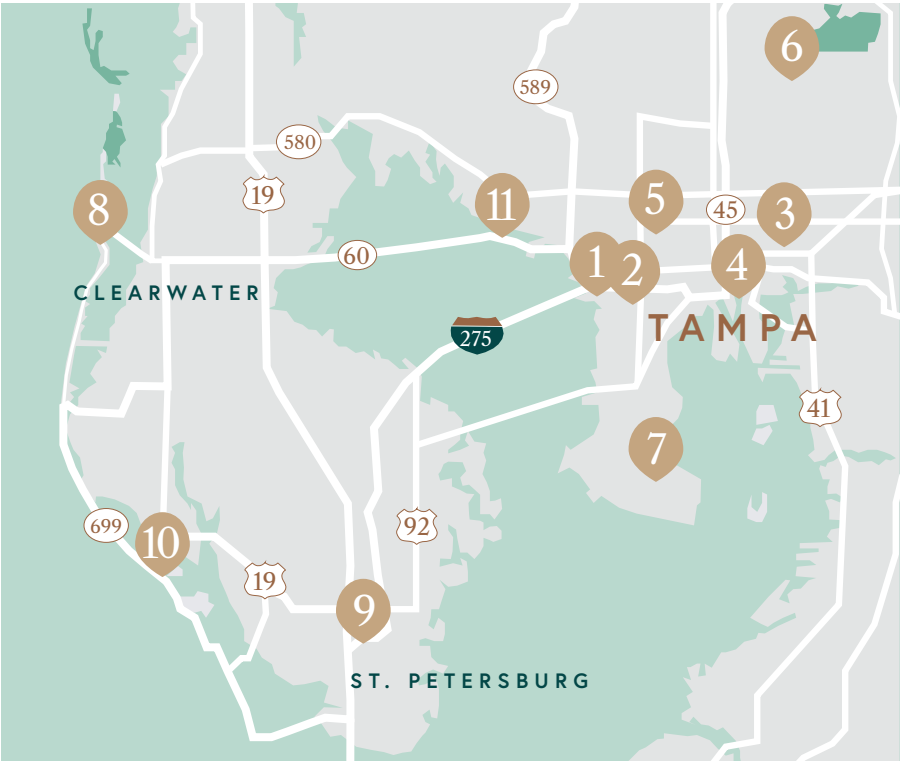

TAMPA BAY MAP

1. Hotel Alba
- 2a. International Plaza
- 2b. Westshore Plaza
3. Ybor City
- 4a. Downtown Tampa
- 4b. Port of Tampa
5. Raymond James Tampa Bay Buccaneers Stadium
6. Busch Gardens Tampa & Adventure Island Tampa
7. MacDill Air Force Base
8. Clearwater Beach
9. St. Petersburg
10. St. Pete Beach, Madeira Beach, Treasure Island
11. Ben T. Davis Beach



ALBA AT A GLANCE

Located in the heart of Tampa's vibrant Westshore business district and a five-minute drive to Tampa International Airport • 222 newly renovated guest rooms and suites • Pool oasis, terrace and seasonal cabana bar 10,000 square feet of meeting and event space plus outdoor terrace perfect for weddings or cocktail hours • On-site restaurant featuring local flavors plus full-service coffee bar serving local roasts & gourmet grab-and-go snacks