

LEVEL 1

HH HIGGINS
HOTEL & CONFERENCE CENTER

PAGE 1

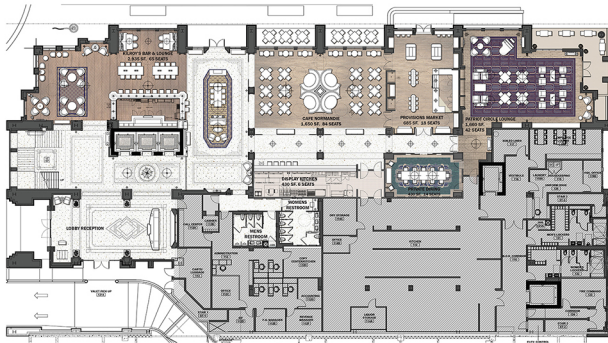

HH HIGGINS

HOTEL & CONFERENCE CENTER

LEVEL 1 OVERALL FLOORPLAN

PAGE 2

ANDREW HIGGINS DRIVE

QUEBEC
MEETING ROOM

MAGAZINE STREET

CONSTANCE STREET

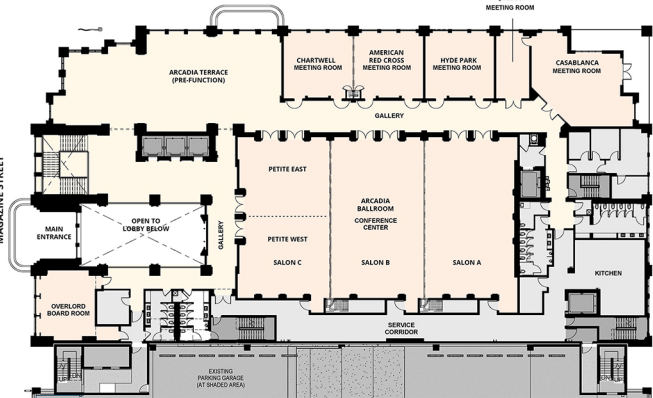

HH HIGGINS
HOTEL & CONFERENCE CENTER

HIGGINS HOTEL & CONFERENCE CENTER MEETING & SPACE CAPACITY CHART

AREA	Dimensions (LxW)	Ceiling Height	SQ FOOTAGE	Crescent Rounds 5	CONFERENCE	USHAPE	CLASSROOM	THEATER	RECEPTION	BANQUET 72"
OVERLORD BOARD ROOM	25x22	14'6" (16@peak)	550	NA	18	NA	NA	NA	NA	18
ARCADIA Terrace (PRE-FUNCTION)	86x38	15 (18@peak)	2925	170	70	NA	120	320	290	243
ARCADIA GALLERY	97x15	15'3" (17'2" @peak)	982	NA	-	NA	-	-	-	-
Lobby Overlook GALLERY	61x50	16'(34@peak)	1658	NA	-	NA	-	-	-	-
CHARTWELL MEETING ROOM	26x25	11'(11'8"@peak)	650	35	15	18	25	70	66	50
AMERICAN RED CROSS MEETING ROOM	26x25	11'(11'8"@peak)	650	35	15	18	25	70	66	50
HYDE PARK MEETING ROOM	26x25	11'(11'8"@peak)	650	35	15	18	25	70	66	50
QUEBEC MEETING ROOM	25x12	11'(11'8"@peak)	300	15	10	9	12	30	30	24
CASABLANCA MEETING ROOM	39x33	11'(11'8"@peak)	975	55	20	28	35	100	98	80
Casablanca Outside Terrace		20' nominal (exterior)	390	25	NA	NA	NA	NA	25	24
Arcadia SALON A	60x35	17'2" (18'6"@peak)	2136	90	50	60	80	220	220	170
Arcadia SALON B	60x35	17'2" (18'6"@peak)	2194	90	50	60	80	220	220	170
Arcadia SALON C	60x35	17'2" (18'6"@peak)	2085	90	50	60	80	220	220	170
* Petit SALON C East	34x31	17'2" (18'6"@peak)	1007	40	25	29	40	110	100	80
* Petit SALON C West	34x31	17'2" (18'6"@peak)	1078	40	25	29	40	110	100	80
Rosie's on the Roof Total (existing seating)			1950		NA	NA	NA	NA	224	NA
* Rosie's on the Roof Interior Bar Area					NA	NA	NA	NA	59	NA
* Rosie's on the Roof Terrace		exterior			NA	NA	NA	12	137	NA
Normandie Private Dining			432	na	34	12	16	na	35	12 Banq
TOTAL			20612						1956	
*Actual Total excluding C East and C West			18170							
Combination Rooms										
ARCADIA BALLROOM (A+B+C)	105x60	17'2" (18'6"@peak)	6566	270	150	180	250	650	650	450
ARCADIA BALLROOM (A+B)	60X70	17'2" (18'6"@peak)	4200	180	80	100	160	450	450	340
Red Cross/Chartwell Combo Room	26x50	11'(11'8"@peak)	1300	75	30	28	56	140	120	100
Arcadia Salon C (Petit East + Petit West)	60x35	17'2" (18'6"@peak)	2085	90	50	60	80	220	220	170

*Blue Shaded cannot be rented as individual private space, but only in conjunction with other space.

