

# CAPACITY CHARTS

## COLONIAL WING

|  | Square Feet | Size            | Ceiling | Reception | Dining | Theatre | Class | U-Shape | Conference |
|--|-------------|-----------------|---------|-----------|--------|---------|-------|---------|------------|
| LT Steak & Seafood<br><i>(Entire)</i>          | 1998        |                 | 11' 6"  |           | 120    |         |       |         |            |
| LT Steak & Seafood<br>Main Dining Room         | 1408        | 44'-5" x 32'    | 11' 6"  |           | 84     |         |       |         |            |
| LT Steak & Seafood<br>Semi-private Dining Room | 590         | 30' x 20'       | 11' 6"  |           | 36     |         |       |         | 20         |
| Lobby Bar                                      | 785         | 29'-4" x 26' 9" | 11' 6"  | 30        |        |         |       |         |            |
| Main Lobby & Bar                               | 1085        |                 | 11' 6"  | 125       |        |         |       |         |            |
| B Bar  | 1100        | 55' x 20'-4"    | 7' 6"   | 90        | 60     | 80      | 40    | 30      | 32         |
| Ocean Front Deck<br><i>(Entire)</i>            | 3750        |                 |         | 200       | 90     |         |       |         |            |
| Ocean Front Deck<br><i>(Upper)</i>             | 1216        | 25'-1" x 52'-3" |         | 50        | 25     |         |       |         |            |
| Ocean Front Deck<br><i>(Lower)</i>             | 1176        | 81'-3" x 18'-1" |         | 125       | 65     |         |       |         |            |

## ART DECO WING

|   | Square Feet | Size                   | Ceiling | Reception | Dining | Theatre | Class | U-Shape | Conference |
|---|-------------|------------------------|---------|-----------|--------|---------|-------|---------|------------|
| Atrium                                  | 3000        | 82' x 36'              |         | 300       | 200    | 250     | 200   |         |            |
| Carlton Room                            | 1683        | 46' x 24';<br>22' x 8' | 11.5'   | 150       | 110    | 135     | 84    | 42      |            |
| Gallery                                 | 1600        | 42' x 36'              | 13'     | 125       | 100    | 150     | 75    | 42      | 32         |
| Art Deco Wing<br>Ground Floor           | 6200        |                        |         | 500       | 350    |         |       |         |            |
| Boardroom                               | 350         | 20' x 14'              |         | 20        | 16     | 20      | 16    | 16      | 16         |
| Library                                 | 414         | 19.5' x 13.5'          | 8'      | 25        | 22     | 30      | 22    | 22      | 22         |
| Rooftop Pool Deck<br><i>(Entire)</i>    | 3412        | 120' x 41'             |         | 250       | 150    | 200     |       |         |            |
| Rooftop Pool Deck<br><i>(East Pool)</i> | 656         | 24' x 20'              |         | 50        | 30     | 20      |       |         |            |
| Rooftop Pool Deck<br><i>(West Pool)</i> | 1200        | 32' x 41'              |         | 120       | 72     | 100     |       |         |            |
| Skyline Deck                            | 1481        | 49' x 24'              |         | 80        | 50     | 120     |       |         |            |
| Rooftop Pool Deck<br><i>(Combined)</i>  | 6800        |                        |         | 500       |        |         |       |         |            |
| Skyline Penthouse<br>& Terrace          | 900         | 22' x 16'              |         | 50        | 30     | 40      |       |         |            |
| The Alley Pizzeria                      | 465         | 17.6' x 26.5'          | 10'     |           | 36     |         |       |         |            |

Ocean Drive

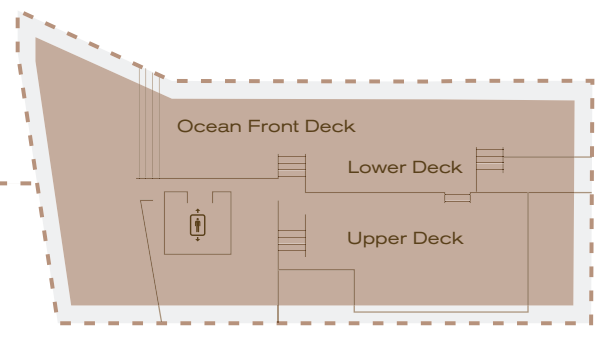
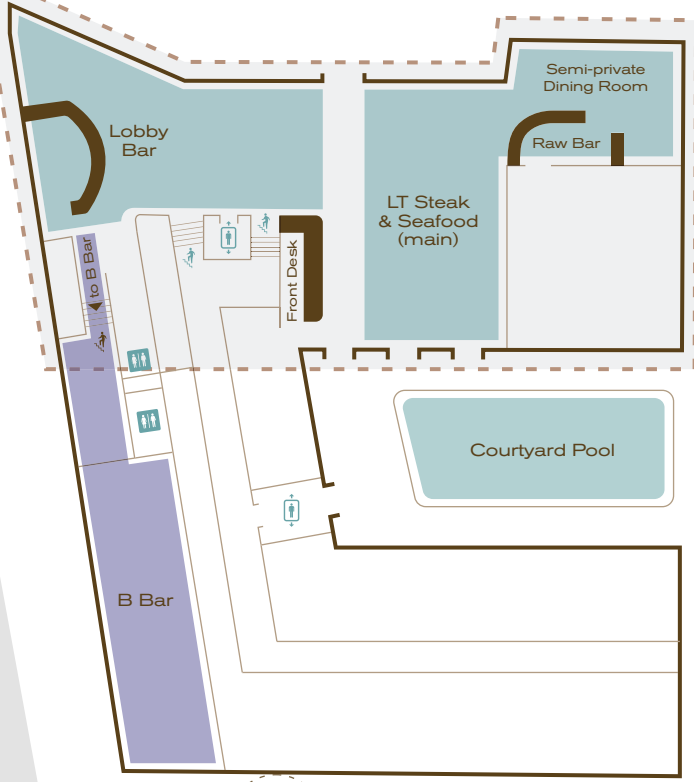

14th Place

The Orb  
(3rd Floor Bridge)

Ocean Court

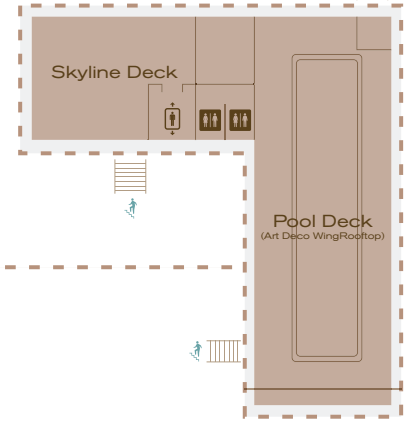
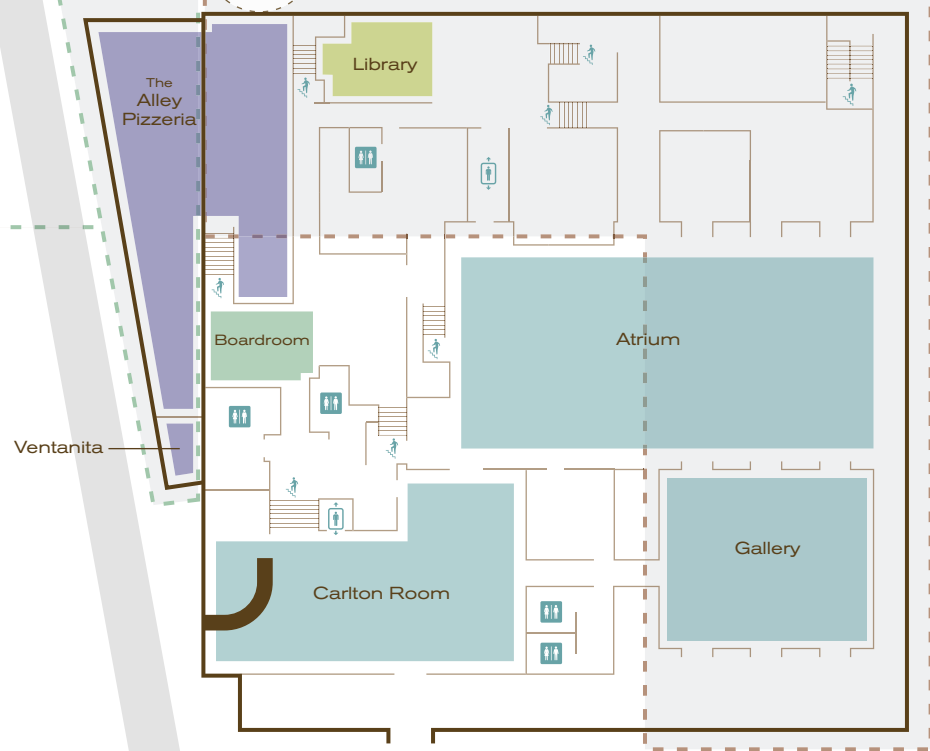
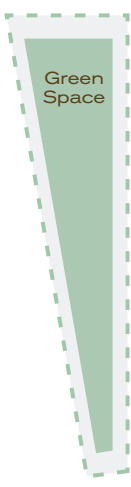

Collins Avenue

- Rooftop
- Third Floor
- Second Floor
- Ground Floor
- Lower Level